

STATE OF MAINE  
STATE HIGHWAY COMMISSION



CRYSTAL STATION ROAD BRIDGE

OVER

INTERSTATE 95

IN THE TOWNS OF

CRYSTAL AND SHERMAN  
AROOSTOOK COUNTY

FEDERAL AID PROJECT NO. I-95 - 9 (41) 266

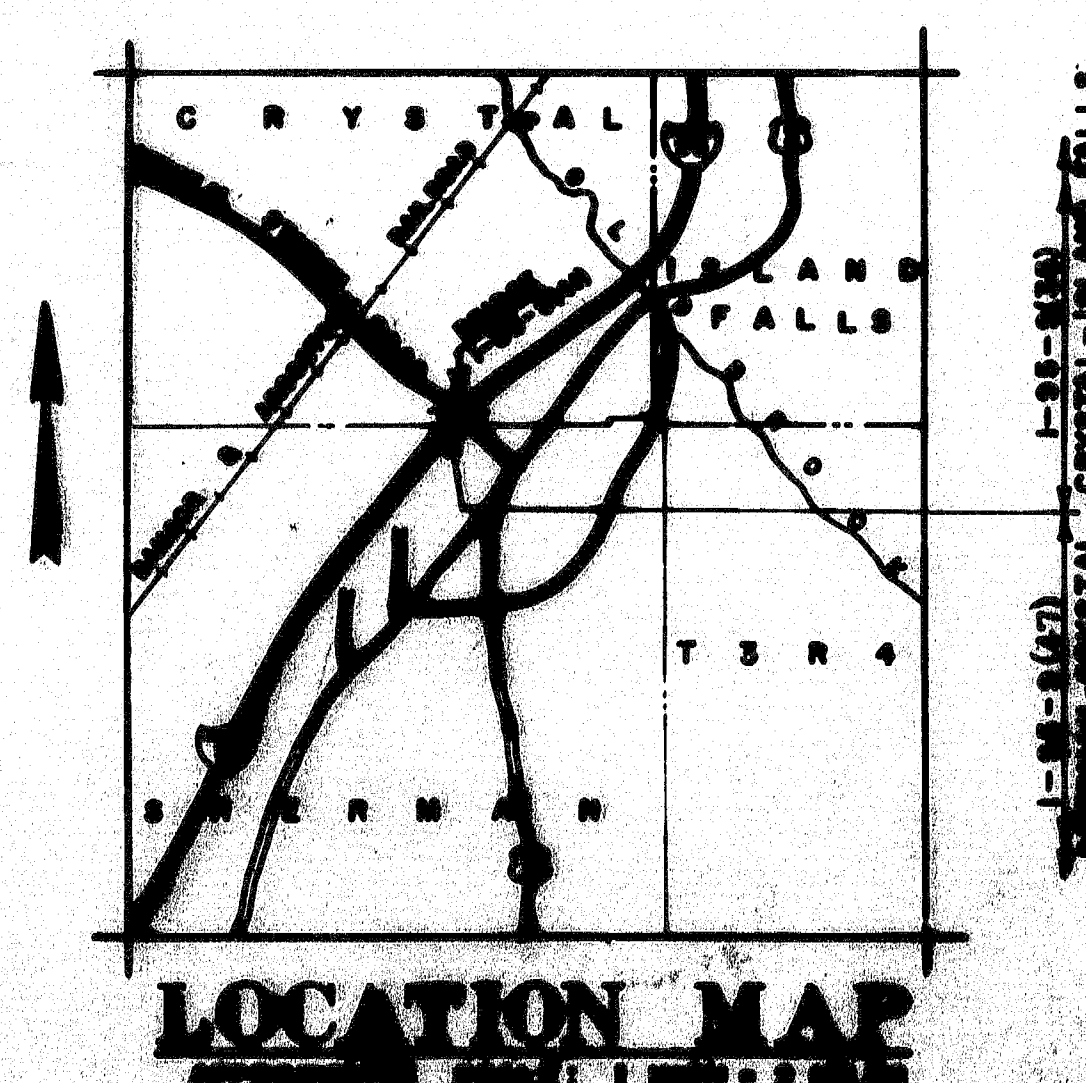

INDEX OF SHEETS

1. TITLE SHEET	STANDARD DETAIL SHEETS
2. TYPICAL CROSS SECTIONS	SD 101-64 BEARING PEDESTALS
3. QUANTITIES	SD 103-64 BEAM SPLICES
4-8. SURVEY	SD 104-64 DIAPHRAGMS, ARMORED JOINT, SHEAR CONNECTORS, DRAIN
9-16. CROSS SECTIONS	SD 105-64 EXPANSION DAMS
17. GENERAL PLAN	SD 107-68 STEEL RAILING
18. FOUNDATION SURVEY	SD 108-68 ALUMINUM RAILING
19. ABUTMENT NO. 1	AUG. 1985 4 SOILS CHART
20. ABUTMENT NO. 2	AUG. 1985 5 GUARD RAIL, TYPE "15"
21. PIERS NO. 1 & NO. 2	
22. SLOPE PROTECTION	
23. STRUCTURAL STEEL	
24. SUPERSTRUCTURE	AUG. 1985 8 ENGINEER'S FIELD OFFICE
25. SUPERSTRUCTURE DETAILS & BLOCKING	
26. REINFORCING STEEL SCHEDULE	

4 LANE REVISION - CHANGE ORDER NO. 4

SHEETS 17, 21, 22, 24, & 25 ARE VOID  
SHEETS 1, 2, 3, 4, 11, 12, 13, 14, 15, 16, 17, 18, 19, 20, 21, 22, 23, 24, 25 ARE REVISED  
SHEETS 26, 27, 28, 29, 30, 31, 32, 33, 34, 35, 36, 37, 38, 39, 40, 41, 42, 43, 44, 45, 46, 47, 48, 49, 50, 51, 52, 53, 54, 55, 56, 57, 58, 59, 60, 61, 62, 63, 64, 65, 66, 67, 68, 69, 70, 71, 72, 73, 74, 75, 76, 77, 78, 79, 80, 81, 82, 83, 84, 85, 86, 87, 88, 89, 90, 91, 92, 93, 94, 95, 96, 97, 98, 99, 100, 101, 102, 103, 104, 105, 106, 107, 108, 109, 110, 111, 112, 113, 114, 115, 116, 117, 118, 119, 120, 121, 122, 123, 124, 125, 126, 127, 128, 129, 130, 131, 132, 133, 134, 135, 136, 137, 138, 139, 140, 141, 142, 143, 144, 145, 146, 147, 148, 149, 150, 151, 152, 153, 154, 155, 156, 157, 158, 159, 160, 161, 162, 163, 164, 165, 166, 167, 168, 169, 170, 171, 172, 173, 174, 175, 176, 177, 178, 179, 180, 181, 182, 183, 184, 185, 186, 187, 188, 189, 190, 191, 192, 193, 194, 195, 196, 197, 198, 199, 200, 201, 202, 203, 204, 205, 206, 207, 208, 209, 210, 211, 212, 213, 214, 215, 216, 217, 218, 219, 220, 221, 222, 223, 224, 225, 226, 227, 228, 229, 230, 231, 232, 233, 234, 235, 236, 237, 238, 239, 240, 241, 242, 243, 244, 245, 246, 247, 248, 249, 250, 251, 252, 253, 254, 255, 256, 257, 258, 259, 260, 261, 262, 263, 264, 265, 266, 267, 268, 269, 270, 271, 272, 273, 274, 275, 276, 277, 278, 279, 280, 281, 282, 283, 284, 285, 286, 287, 288, 289, 290, 291, 292, 293, 294, 295, 296, 297, 298, 299, 300, 301, 302, 303, 304, 305, 306, 307, 308, 309, 310, 311, 312, 313, 314, 315, 316, 317, 318, 319, 320, 321, 322, 323, 324, 325, 326, 327, 328, 329, 330, 331, 332, 333, 334, 335, 336, 337, 338, 339, 340, 341, 342, 343, 344, 345, 346, 347, 348, 349, 350, 351, 352, 353, 354, 355, 356, 357, 358, 359, 360, 361, 362, 363, 364, 365, 366, 367, 368, 369, 370, 371, 372, 373, 374, 375, 376, 377, 378, 379, 380, 381, 382, 383, 384, 385, 386, 387, 388, 389, 390, 391, 392, 393, 394, 395, 396, 397, 398, 399, 400, 401, 402, 403, 404, 405, 406, 407, 408, 409, 410, 411, 412, 413, 414, 415, 416, 417, 418, 419, 420, 421, 422, 423, 424, 425, 426, 427, 428, 429, 430, 431, 432, 433, 434, 435, 436, 437, 438, 439, 440, 441, 442, 443, 444, 445, 446, 447, 448, 449, 450, 451, 452, 453, 454, 455, 456, 457, 458, 459, 460, 461, 462, 463, 464, 465, 466, 467, 468, 469, 470, 471, 472, 473, 474, 475, 476, 477, 478, 479, 480, 481, 482, 483, 484, 485, 486, 487, 488, 489, 490, 491, 492, 493, 494, 495, 496, 497, 498, 499, 500, 501, 502, 503, 504, 505, 506, 507, 508, 509, 510, 511, 512, 513, 514, 515, 516, 517, 518, 519, 520, 521, 522, 523, 524, 525, 526, 527, 528, 529, 530, 531, 532, 533, 534, 535, 536, 537, 538, 539, 540, 541, 542, 543, 544, 545, 546, 547, 548, 549, 550, 551, 552, 553, 554, 555, 556, 557, 558, 559, 560, 561, 562, 563, 564, 565, 566, 567, 568, 569, 570, 571, 572, 573, 574, 575, 576, 577, 578, 579, 580, 581, 582, 583, 584, 585, 586, 587, 588, 589, 590, 591, 592, 593, 594, 595, 596, 597, 598, 599, 600, 601, 602, 603, 604, 605, 606, 607, 608, 609, 610, 611, 612, 613, 614, 615, 616, 617, 618, 619, 620, 621, 622, 623, 624, 625, 626, 627, 628, 629, 630, 631, 632, 633, 634, 635, 636, 637, 638, 639, 640, 641, 642, 643, 644, 645, 646, 647, 648, 649, 650, 651, 652, 653, 654, 655, 656, 657, 658, 659, 660, 661, 662, 663, 664, 665, 666, 667, 668, 669, 670, 671, 672, 673, 674, 675, 676, 677, 678, 679, 680, 681, 682, 683, 684, 685, 686, 687, 688, 689, 690, 691, 692, 693, 694, 695, 696, 697, 698, 699, 700, 701, 702, 703, 704, 705, 706, 707, 708, 709, 710, 711, 712, 713, 714, 715, 716, 717, 718, 719, 720, 721, 722, 723, 724, 725, 726, 727, 728, 729, 730, 731, 732, 733, 734, 735, 736, 737, 738, 739, 740, 741, 742, 743, 744, 745, 746, 747, 748, 749, 750, 751, 752, 753, 754, 755, 756, 757, 758, 759, 760, 761, 762, 763, 764, 765, 766, 767, 768, 769, 770, 771, 772, 773, 774, 775, 776, 777, 778, 779, 780, 781, 782, 783, 784, 785, 786, 787, 788, 789, 790, 791, 792, 793, 794, 795, 796, 797, 798, 799, 800, 801, 802, 803, 804, 805, 806, 807, 808, 809, 810, 811, 812, 813, 814, 815, 816, 817, 818, 819, 820, 821, 822, 823, 824, 825, 826, 827, 828, 829, 830, 831, 832, 833, 834, 835, 836, 837, 838, 839, 840, 841, 842, 843, 844, 845, 846, 847, 848, 849, 850, 851, 852, 853, 854, 855, 856, 857, 858, 859, 860, 861, 862, 863, 864, 865, 866, 867, 868, 869, 870, 871, 872, 873, 874, 875, 876, 877, 878, 879, 880, 881, 882, 883, 884, 885, 886, 887, 888, 889, 890, 891, 892, 893, 894, 895, 896, 897, 898, 899, 900, 901, 902, 903, 904, 905, 906, 907, 908, 909, 910, 911, 912, 913, 914, 915, 916, 917, 918, 919, 920, 921, 922, 923, 924, 925, 926, 927, 928, 929, 930, 931, 932, 933, 934, 935, 936, 937, 938, 939, 940, 941, 942, 943, 944, 945, 946, 947, 948, 949, 950, 951, 952, 953, 954, 955, 956, 957, 958, 959, 960, 961, 962, 963, 964, 965, 966, 967, 968, 969, 970, 971, 972, 973, 974, 975, 976, 977, 978, 979, 980, 981, 982, 983, 984, 985, 986, 987, 988, 989, 990, 991, 992, 993, 994, 995, 996, 997, 998, 999, 1000, 1001, 1002, 1003, 1004, 1005, 1006, 1007, 1008, 1009, 1010, 1011, 1012, 1013, 1014, 1015, 1016, 1017, 1018, 1019, 1020, 1021, 1022, 1023, 1024, 1025, 1026, 1027, 1028, 1029, 1030, 1031, 1032, 1033, 1034, 1035, 1036, 1037, 1038, 1039, 1040, 1041, 1042, 1043, 1044, 1045, 1046, 1047, 1048, 1049, 1050, 1051, 1052, 1053, 1054, 1055, 1056, 1057, 1058, 1059, 1060, 1061, 1062, 1063, 1064, 1065, 1066, 1067, 1068, 1069, 1070, 1071, 1072, 1073, 1074, 1075, 1076, 1077, 1078, 1079, 1080, 1081, 1082, 1083, 1084, 1085, 1086, 1087, 1088, 1089, 1090, 1091, 1092, 1093, 1094, 1095, 1096, 1097, 1098, 1099, 1100, 1101, 1102, 1103, 1104, 1105, 1106, 1107, 1108, 1109, 1110, 1111, 1112, 1113, 1114, 1115, 1116, 1117, 1118, 1119, 1120, 1121, 1122, 1123, 1124, 1125, 1126, 1127, 1128, 1129, 1130, 1131, 1132, 1133, 1134, 1135, 1136, 1137, 1138, 1139, 1140, 1141, 1142, 1143, 1144, 1145, 1146, 1147, 1148, 1149, 1150, 1151, 1152, 1153, 1154, 1155, 1156, 1157, 1158, 1159, 1160, 1161, 1162, 1163, 1164, 1165, 1166, 1167, 1168, 1169, 1170, 1171, 1172, 1173, 1174, 1175, 1176, 1177, 1178, 1179, 1180, 1181, 1182, 1183, 1184, 1185, 1186, 1187, 1188, 1189, 1190, 1191, 1192, 1193, 1194, 1195, 1196, 1197, 1198, 1199, 1200, 1201, 1202, 1203, 1204, 1205, 1206, 1207, 1208, 1209, 1210, 1211, 1212, 1213, 1214, 1215, 1216, 1217, 1218, 1219, 1220, 1221, 1222, 1223, 1224, 1225, 1226, 1227, 1228, 1229, 1230, 1231, 1232, 1233, 1234, 1235, 1236, 1237, 1238, 1239, 1240, 1241, 1242, 1243, 1244, 1245, 1246, 1247, 1248, 1249, 1250, 1251, 1252, 1253, 1254, 1255, 1256, 1257, 1258, 1259, 1260, 1261, 1262, 1263, 1264, 1265, 1266, 1267, 1268, 1269, 1270, 1271, 1272, 1273, 1274, 1275, 1276, 1277, 1278, 1279, 1280, 1281, 1282, 1283, 1284, 1285, 1286, 1287, 1288, 1289, 1290, 1291, 1292, 1293, 1294, 1295, 1296, 1297, 1298, 1299, 1300, 1301, 1302, 1303, 1304, 1305, 1306, 1307, 1308, 1309, 1310, 1311, 1312, 1313, 1314, 1315, 1316, 1317, 1318, 1319, 1320, 1321, 1322, 1323, 1324, 1325, 1326, 1327, 1328, 1329, 1330, 1331, 1332, 1333, 1334, 1335, 1336, 1337, 1338, 1339, 1340, 1341, 1342, 1343, 1344, 1345, 1346, 1347, 1348, 1349, 1350, 1351, 1352, 1353, 1354, 1355, 1356, 1357, 1358, 1359, 1360, 1361, 1362, 1363, 1364, 1365, 1366, 1367, 1368, 1369, 1370, 1371, 1372, 1373, 1374, 1375, 1376, 1377, 1378, 1379, 1380, 1381, 1382, 1383, 1384, 1385, 1386, 1387, 1388, 1389, 1390, 1391, 1392, 1393, 1394, 1395, 1396, 1397, 1398, 1399, 1400, 1401, 1402, 1403, 1404, 1405, 1406, 1407, 1408, 1409, 1410, 1411, 1412, 1413, 1414, 1415, 1416, 1417, 1418, 1419, 1420, 1421, 1422, 1423, 1424, 1425, 1426, 1427, 1428, 1429, 1430, 1431, 1432, 1433, 1434, 1435, 1436, 1437, 1438, 1439, 1440, 1441, 1442, 1443, 1444, 1445, 1446, 1447, 1448, 1449, 1450, 1451, 1452, 1453, 1454, 1455, 1456, 1457, 1458, 1459, 1460, 1461, 1462, 1463, 1464, 1465, 1466, 1467, 1468, 1469, 1470, 1471, 1472, 1473, 1474, 1475, 1476, 1477, 1478, 1479, 1480, 1481, 1482, 1483, 1484, 1485, 1486, 1487, 1488, 1489, 1490, 1491, 1492, 1493, 1494, 1495, 1496, 1497, 1498, 1499, 1500, 1501, 1502, 1503, 1504, 1505, 1506, 1507, 1508, 1509, 1510, 1511, 1512, 1513, 1514, 1515, 1516, 1517, 1518, 1519, 1520, 1521, 1522, 1523, 1524, 1525, 1526, 1527, 1528, 1529, 1530, 1531, 1532, 1533, 1534, 1535, 1536, 1537, 1538, 1539, 1540, 1541, 1542, 1543, 1544, 1545, 1546, 1547, 1548, 1549, 1550, 1551, 1552, 1553, 1554, 1555, 1556, 1557, 1558, 1559, 1560, 1561, 1562, 1563, 1564, 1565, 1566, 1567, 1568, 1569, 1570, 1571, 1572, 1573, 1574, 1575, 1576, 1577, 1578, 1579, 1580, 1581, 1582, 1583, 1584, 1585, 1586, 1587, 1588, 1589, 1590, 1591, 1592, 1593, 1594, 1595, 1596, 1597, 1598, 1599, 1600, 1601, 1602, 1603, 1604, 1605, 1606, 1607, 1608, 1609, 1610, 1611, 1612, 1613, 1614, 1615, 1616, 1617, 1618, 1619, 1620, 1621, 1622, 1623, 1624, 1625, 1626, 1627, 1628, 1629, 1630, 1631, 1632, 1633, 1634, 1635, 1636, 1637, 1638, 1639, 1640, 1641, 1642, 1643, 1644, 1645, 1646, 1647, 1648, 1649, 1650, 1651, 1652, 1653, 1654, 1655, 1656, 1657, 1658, 1659, 1660, 1661, 1662, 1663, 1664, 1665, 1666, 1667, 1668, 1669, 1670, 1671, 1672, 1673, 1674, 1675, 1676, 1677, 1678, 1679, 1680, 1681, 1682, 1683, 1684, 1685, 1686, 1687, 1688, 1689, 1690, 1691, 1692, 1693, 1694, 1695, 1696, 1697, 1698, 1699, 1700, 1701, 1702, 1703, 1704, 1705, 1706, 1707, 1708, 1709, 1710, 1711, 1712, 1713, 1714, 1715, 1716, 1717, 1718, 1719, 1720, 1721, 1722, 1723, 1724, 1725, 1726, 1727, 1728, 1729, 1730, 1731, 1732, 1733, 1734, 1735, 1736, 1737, 1738, 1739, 1740, 1741, 1742, 1743, 1744, 1745, 1746, 1747, 1748, 1749, 1750, 1751, 1752, 1753, 1754, 1755, 1756, 1757, 1758, 1759, 1760, 1761, 1762, 1763, 1764, 1765, 1766, 1767, 1768, 1769, 1770, 1771, 1772, 1773, 1774, 1775, 1776, 1777, 1778, 1779, 1780, 1781, 1782, 1783, 1784, 1785, 1786, 1787, 1788, 1789, 1790, 1791, 1792, 1793, 1794, 1795, 1796, 1797, 1798, 1799, 1800, 1801, 1802, 1803, 1804, 1805, 1806, 1807, 1808, 1809, 1810, 1811, 1812, 1813, 1814, 1815, 1816, 1817, 1818, 1819, 1820, 1821, 1822, 1823, 1824, 1825, 1826, 1827, 1828, 1829, 1830, 1831, 1832, 1833, 1834, 1835, 1836, 1837, 1838, 1839, 1840, 1841, 1842, 1843, 1844, 1845, 1846, 1847, 1848, 1849, 1850, 1851, 1852, 1853, 1854, 1855, 1856, 1857, 1858, 1859, 1860, 1861, 1862, 1863, 1864, 1865, 1866, 1867, 1868, 1869, 1870, 1871, 1872, 1873, 1874, 1875, 1876, 1877, 1878, 1879, 1880, 1881, 1882, 1883, 1884, 1885, 1886, 1887, 1888, 1889, 1890, 1891, 1892, 1893, 1894, 1895, 1896, 1897, 1898, 1899, 1900, 1901, 1902, 1903, 1904, 1905, 1906, 1907, 1908, 1909, 1910, 1911, 1912, 1913, 1914, 1915, 1916, 1917, 1918, 1919, 1920, 1921, 1922, 1923, 1924, 1925, 1926, 1927, 1928, 1929, 1930, 1931, 1932, 1933, 1934, 1935, 1936, 1937, 1938, 1939, 1940, 1941, 1942, 1943, 1944, 1945, 1946, 1947, 1948, 1949, 1950, 1951, 1952, 1953, 1954, 1955, 1956, 1957, 1958, 1959, 1960, 1961, 1962, 1963, 1964, 1965, 1966, 1967, 1968, 1969, 1970, 1971, 1972, 1973, 1974, 1975, 1976, 1977, 1978, 1979, 1980, 1981, 1982, 1983, 1984, 1985, 1986, 1987, 1988, 1989, 1990, 1991, 1992, 1993, 1994, 1995, 1996, 1997, 1998, 1999, 2000, 2001, 2002, 2003, 2004, 2005, 2006, 2007, 2008, 2009, 2010, 2011, 2012, 2013, 2014, 2015, 2016, 2017, 2018, 2019, 2020, 2021, 2022, 2023, 2024, 2025, 2026, 2027, 2028, 2029, 2030, 2031, 2032, 2033, 2034, 203



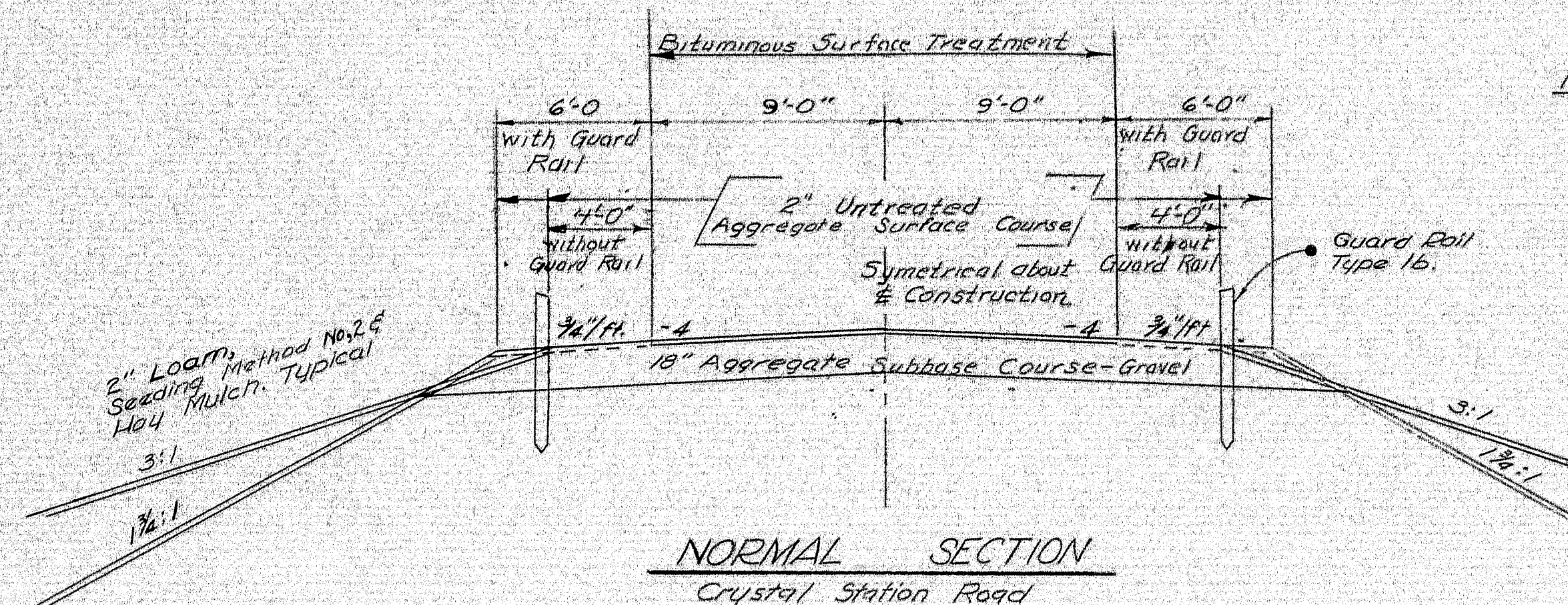

NOTE: Bituminous Surface Treatment shall be in accordance with SECTION 410 and shall consist of the following:

1. SECTION 408 - PRIME COAT, Road Tar R.T.-5 @ 0.5 gals.± per s.y.
2. SECTION 409 - SEAL COAT, Road Tar R.T.-5 @ 0.2 gals.± per s.y.

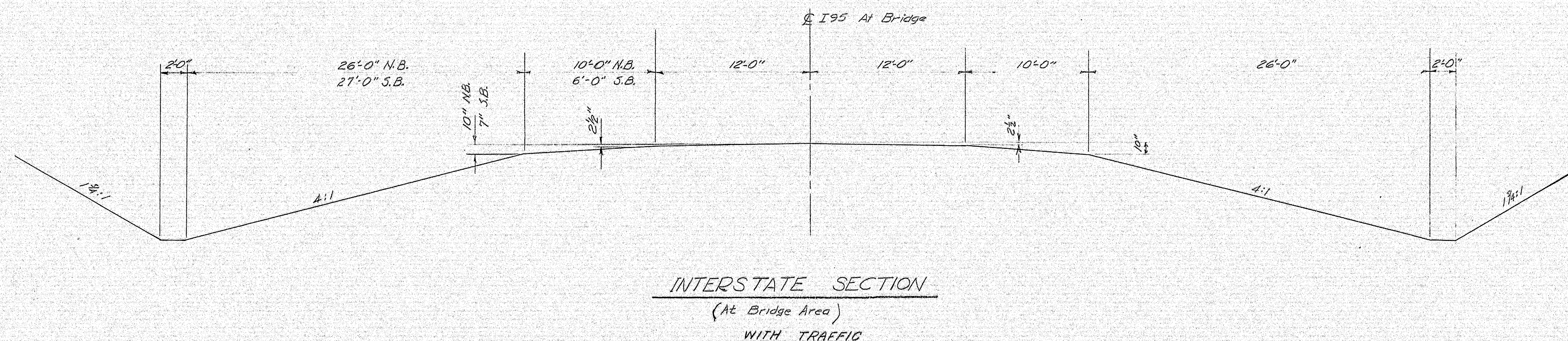
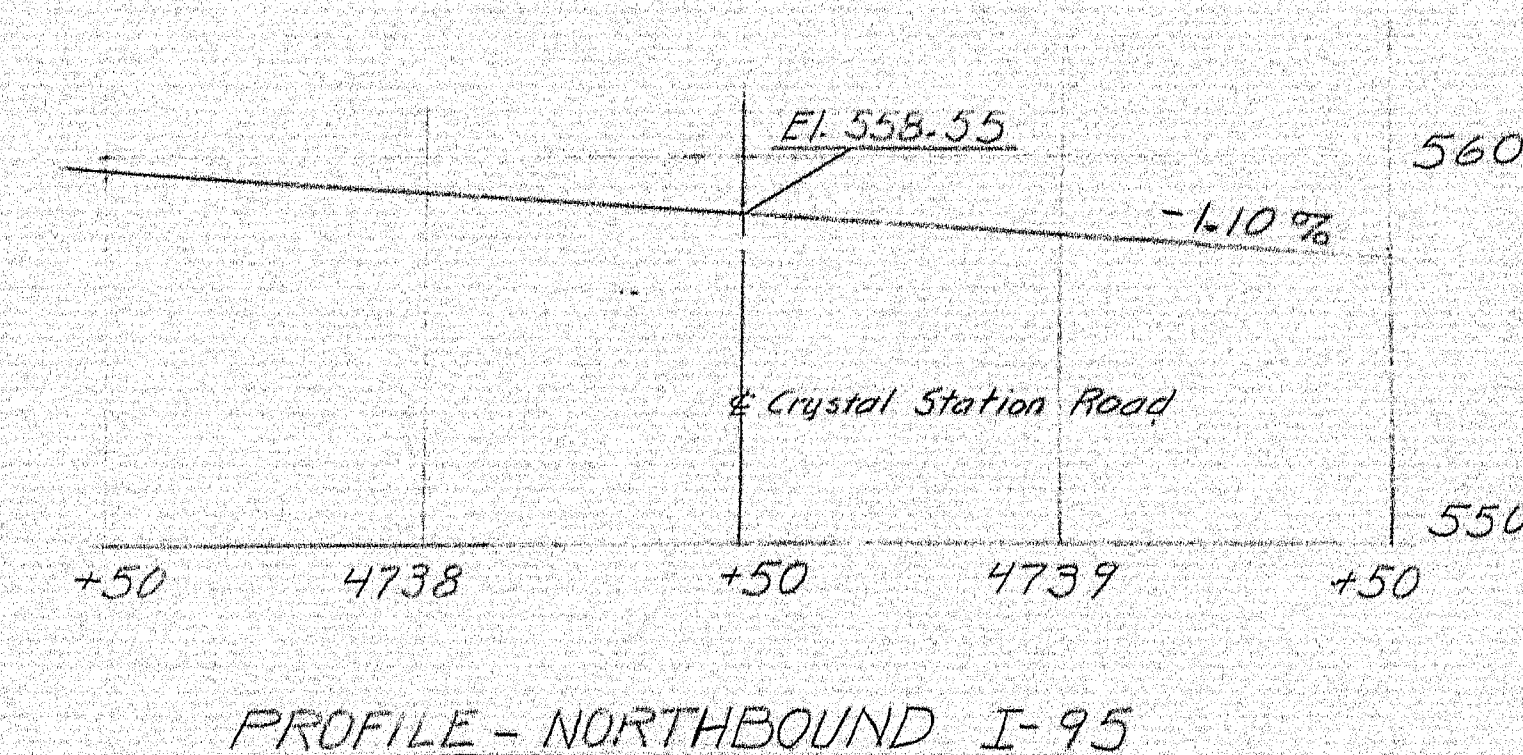
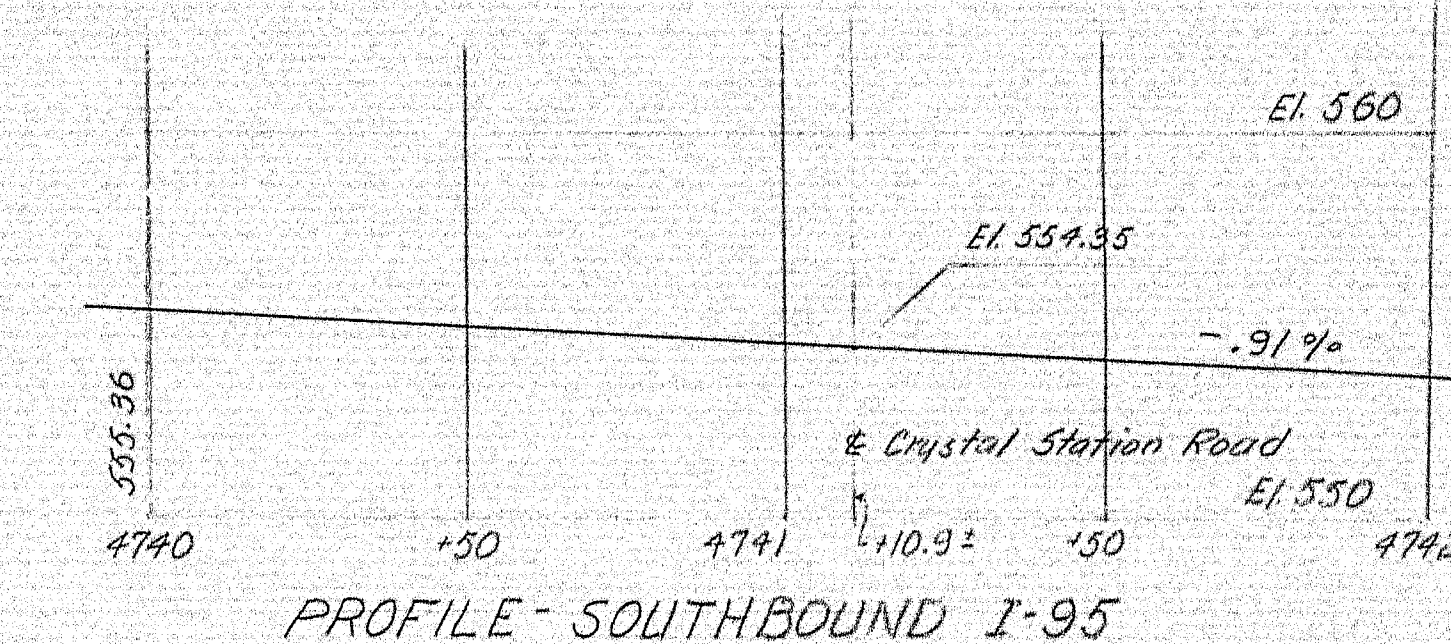
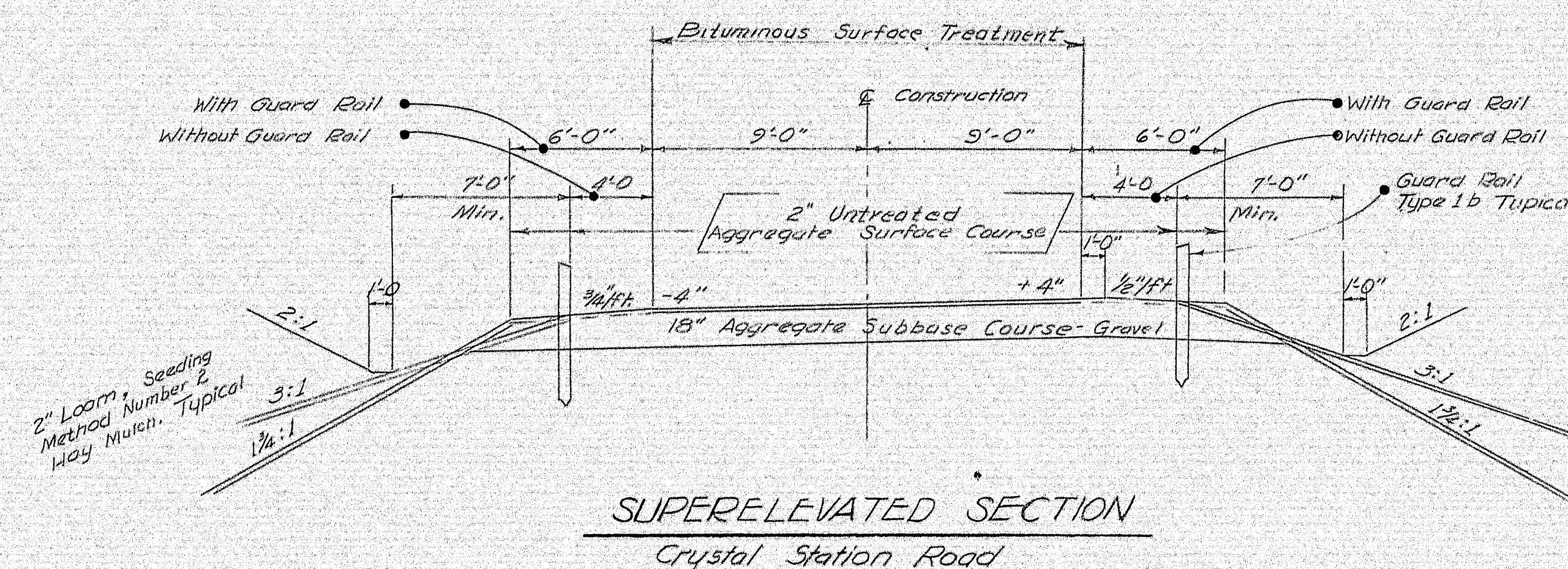
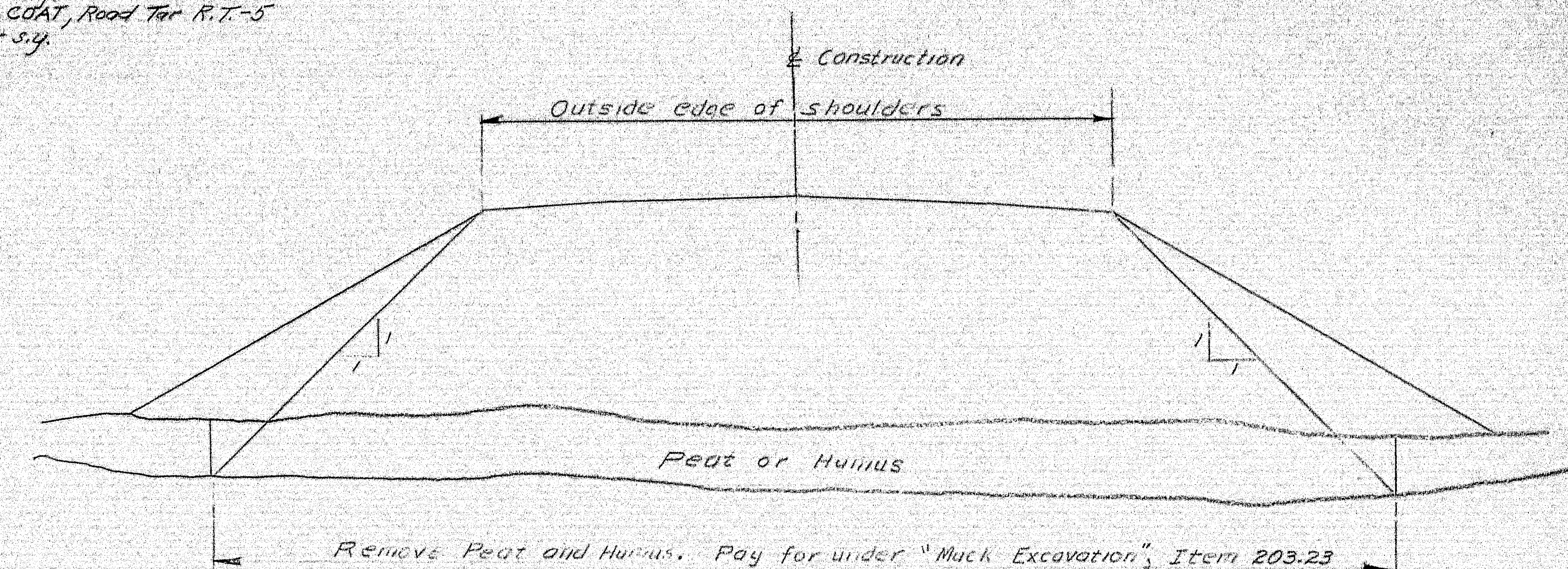

4 LANE REVISION NOVEMBER 1966

DESIGN: AHR  
TRACE: MEYS  
CHECK: (initials)

BRIDGE NO. 101-2  
SURVEY: 1965  
PLOT: 1966

STATE HIGHWAY COMMISSION  
BRIDGE DIVISION

**CRYSTAL STATION ROAD BRIDGE**  
OVER  
**INTERSTATE 95**  
IN THE TOWNS OF  
**CRYSTAL & SHERMAN**  
**AROOSTOOK COUNTY**  
TYPICAL CROSS-SECTIONS

SHEET 2 OF 26 AUGUSTA, MAINE JAN 1966

101-2

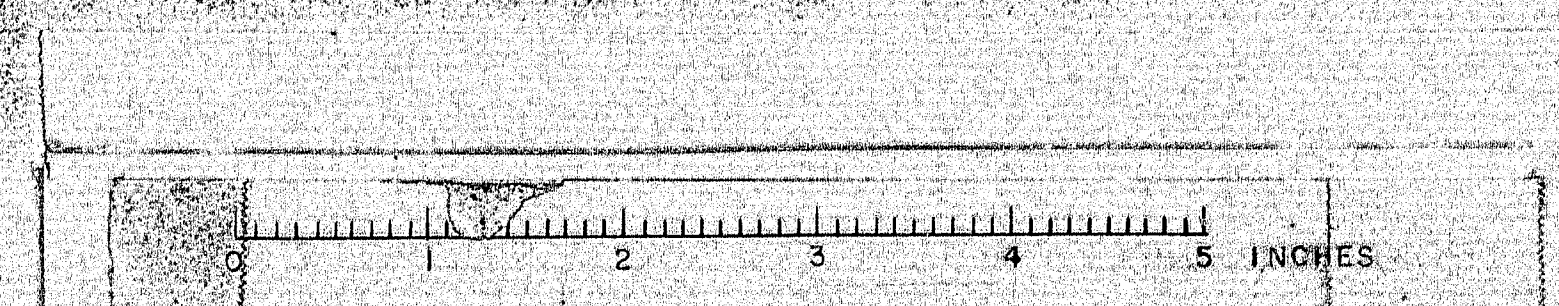



ESTIMATED QUANTITIES

DESCRIPTION	UNIT	STRUCTURE	TOTAL	DESCRIPTION	UNIT	STRUCTURE	TOTAL
Common Excavation	Cu. Yds.	—	3100	Bridge Railing	L. F.	372	372
Rock Excavation	Cu. Yds.	—	220	Membrane Waterproofing	Sq. Yds.	448	448
Muck Excavation	Cu. Yds.	—	3900	Slope Protection	Sq. Yds.	350	350
Common Borrow	Cu. Yds.	—	107,000	Curing Box for Concrete Cylinders	Each	1	1
Gravel Borrow	Cu. Yds.	—	5800	Epoxy Resin Surface Sealant	Sq. Yds.	64	64
Structural Earth Excavation - Drainage and Minor Structures	Cu. Yds.	—	170	12" Culvert Pipe	L. F.	—	48
Structural Earth Excavation - Piers	Cu. Yds.	150	150	15" Culvert Pipe	L. F.	—	30
				18" Culvert Pipe	L. F.	—	56
Aggregate Subbase Course - Gravel	Cu. Yds.	—	5100	48" Bituminous Coated Corrugated Metal Pipe	L. F.	—	86
Hot Bituminous Pavement (Grading C-1)	Ton	50	50	Guard Rail - Type 1b	L. F.	—	3000
Bituminous Material for Prime Coat	Gallon	—	2950	Anchorage for Cable Guard Rail	Each	—	4
Blotter Material	Cu. Yds.	—	25	Vertical Bridge Curb - Type 1	L. F.	395	395
Bituminous Material for Seal Coat	Gallon	—	1200	Loam	Cu. Yds.	—	1050
Cover Coat Material - Sand	Cu. Yds.	—	25	Seeding - Method No. 2	Unit	—	170
Untreated Aggregate Surface Course	Cu. Yds.	—	500	Hay Mulch	Tons	—	12
Structural Concrete - Abutments & Retaining Walls	Cu. Yds.	126	126	Field Office, Type "B"	Each	—	1
Structural Concrete - Piers	Cu. Yds.	87	87				
Structural Concrete - Roadway & Sidewalk Slabs on Steel Bridges	L. S.	L. S.	L. S.				
Structural Concrete - Approach Slabs	L. S.	L. S.	L. S.				
Reinforcing Steel - Fabricated and Delivered	Lbs.	50800	50800				
Reinforcing Steel - Placing	Lbs.	50800	50800				
Structural Steel - Fabricated and Delivered	L. S.	L. S.	L. S.				
Structural Steel - Erection	L. S.	L. S.	L. S.				
Field Painting - Structural Steel	L. S.	L. S.	L. S.				

Note:

a. The approximate weight of structural steel based on nominal sizes, but not including the weight of welds, nuts, bolts, washers or rivets is 117,000 pounds.

b. Estimated quantity of structural concrete for the following:

1. Struct. Concrete, Roadway & Sidewalk Slabs on Steel Bridges = 158 cu.yds.
2. Struct. Concrete, Approach Slabs = 16 cu.yds.

NOTE:

Quantities do not include change order No. 4

4 LANE REVISION NOVEMBER 1966

E.B.S. V.M.

DESIGN—  
TRACE—  
CHECK—

DETAIL - P. J. M.

BRIDGE NO.  
SURVEY—  
PLOT—

STATE HIGHWAY COMMISSION  
BRIDGE DIVISION

CRYSTAL STATION ROAD BRIDGE  
OVER  
INTERSTATE 95  
IN THE TOWNS OF  
CRYSTAL & SHERMAN  
AROOSTOOK COUNTY

QUANTITIES

SHEET 3 OF 26 AUGUSTA, MAINE

101-3





U.S.G.S.  
Sta. 23+80, 26' R.L.  
Elevation - 543.43

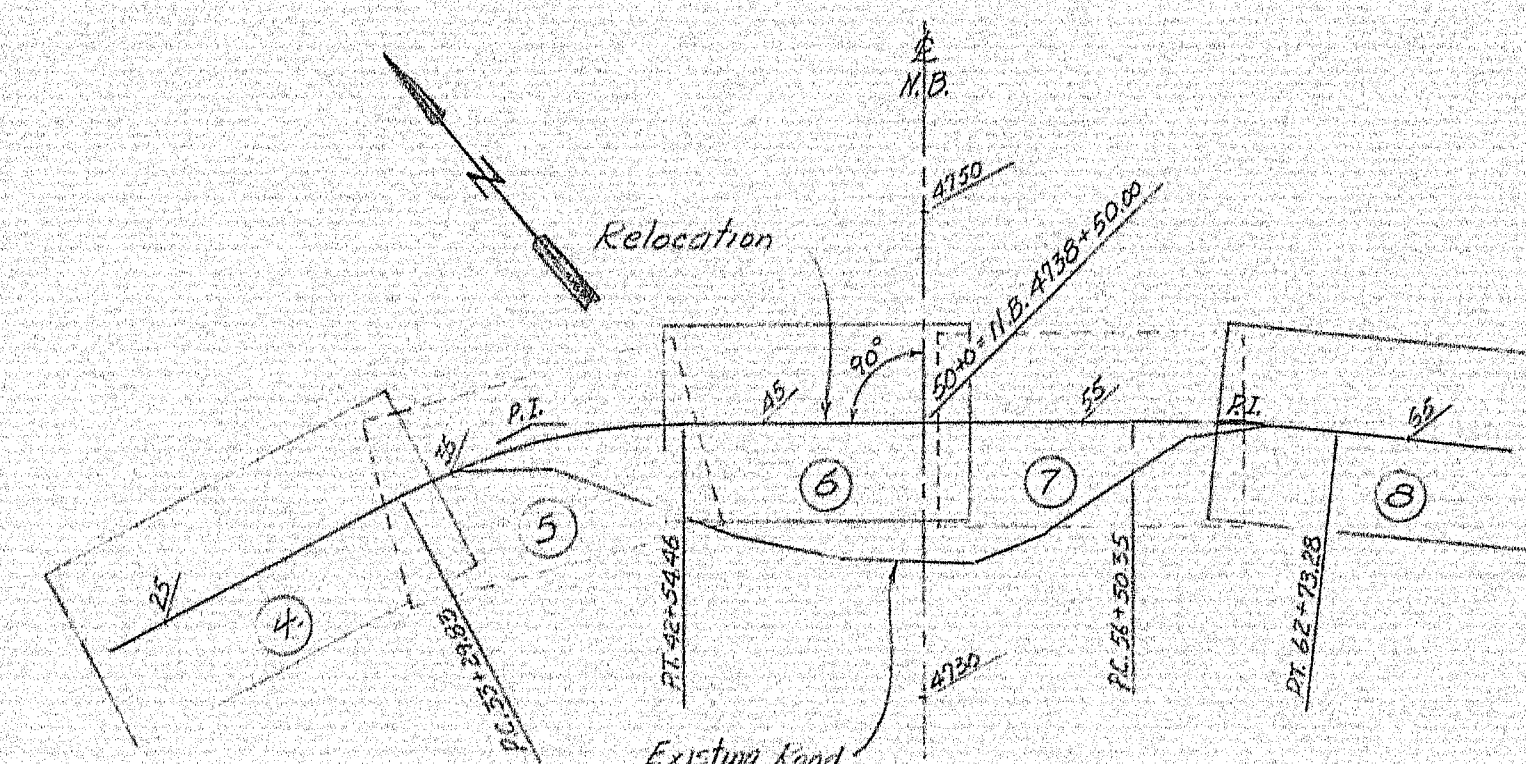
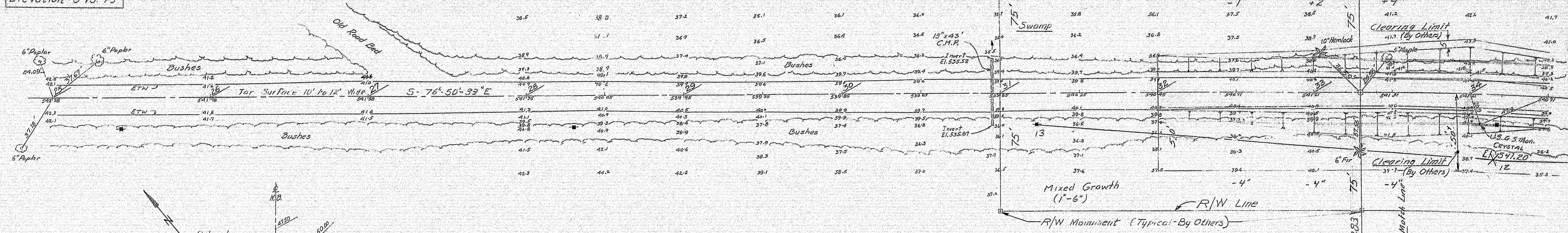

**UTILITY**  
Maine Public Service Company  
NOTE - All utility plant to be adjusted by the respective utilities, unless otherwise noted.  
\* Existing Power Pole  
X - Proposed Permanent Pole Locations

**PLAN**  
Scale 1" = 30'  
NOTE: All elevations preceded by 5 as along Const. L.

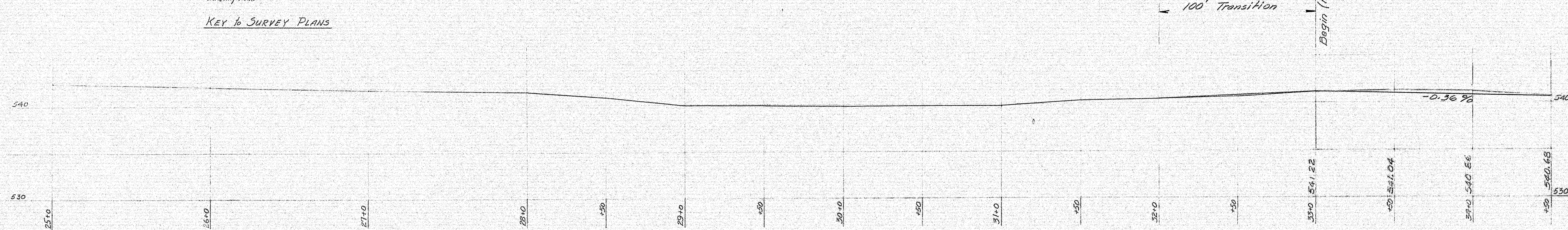

**PROFILE**  
Scales: Horiz. 1" = 30'  
Vert. 1" = 5'

4 LANE REVISION		NOVEMBER 1966	
DESIGN - A.L.L., R.T.B. & H.R.	BRIDGE NO. 95-1037	E.H.S. V.H.	
CHECK - P.W.	FLY - E. Forster		
STATE HIGHWAY COMMISSION BRIDGE DIVISION			
CRYSTAL STATION ROAD BRIDGE			
OVER			
INTERSTATE 95			
IN THE TOWNS OF			
CRYSTAL & SHERMAN			
AROOSTOOK COUNTY			
SURVEY			
SHEET 4 OF 26		AUGUSTA, MAINE MAY 1965	

101-4

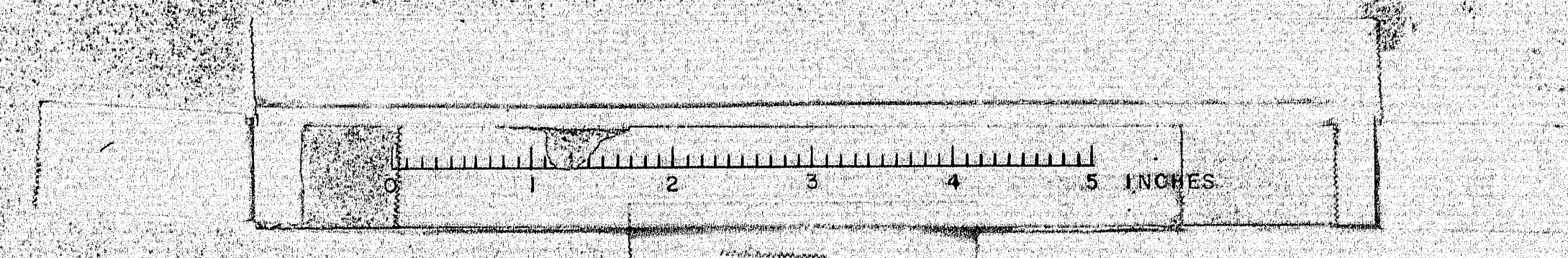











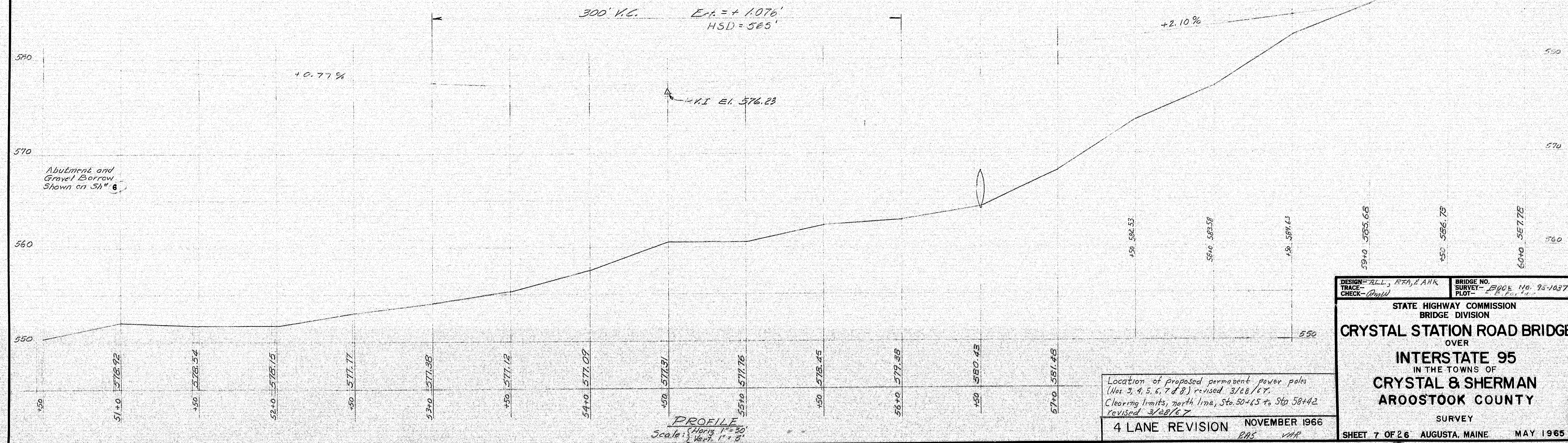
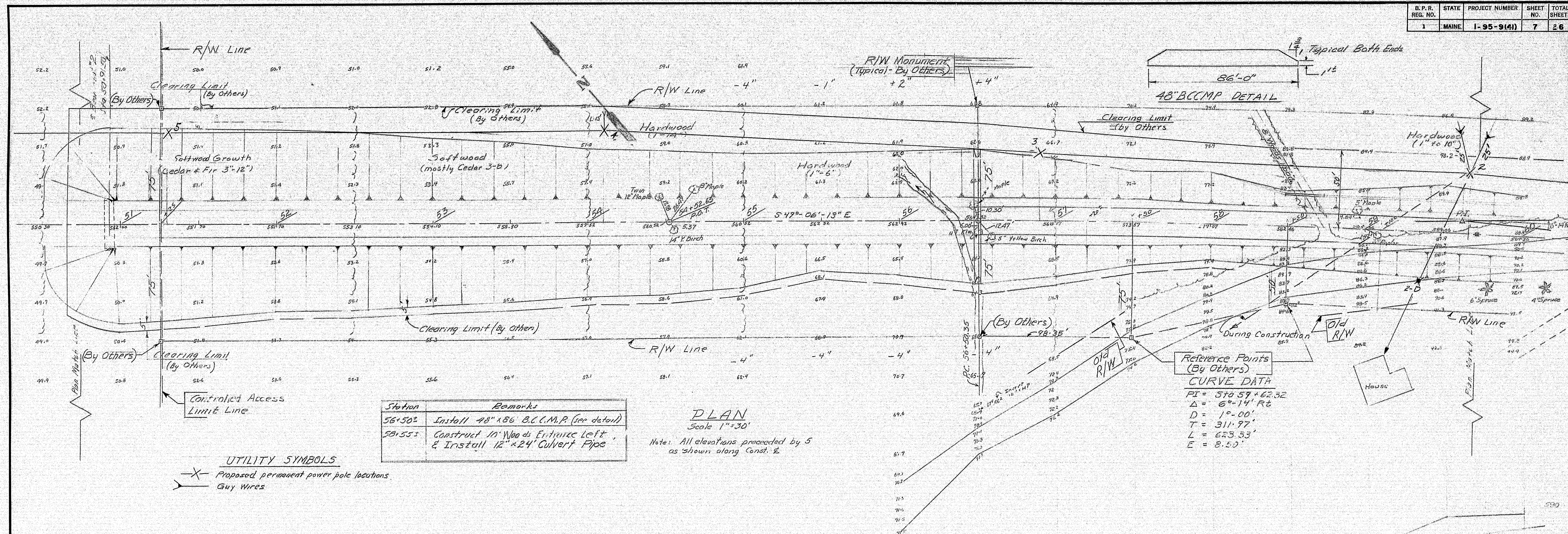

DESIGN - ALL, RPA, LANK  
 CHECK - (P)W

BRIDGE NO. 1005  
 SURVEY PLOT

STATE HIGHWAY COMMISSION  
 BRIDGE DIVISION

**CRYSTAL STATION ROAD BRIDGE**  
 OVER  
**INTERSTATE 95**  
 IN THE TOWNS OF  
**CRYSTAL & SHERMAN**  
**AROOSTOOK COUNTY**  
 SURVEY

SHEET 7 OF 26 AUGUSTA, MAINE MAY 1965

101-7



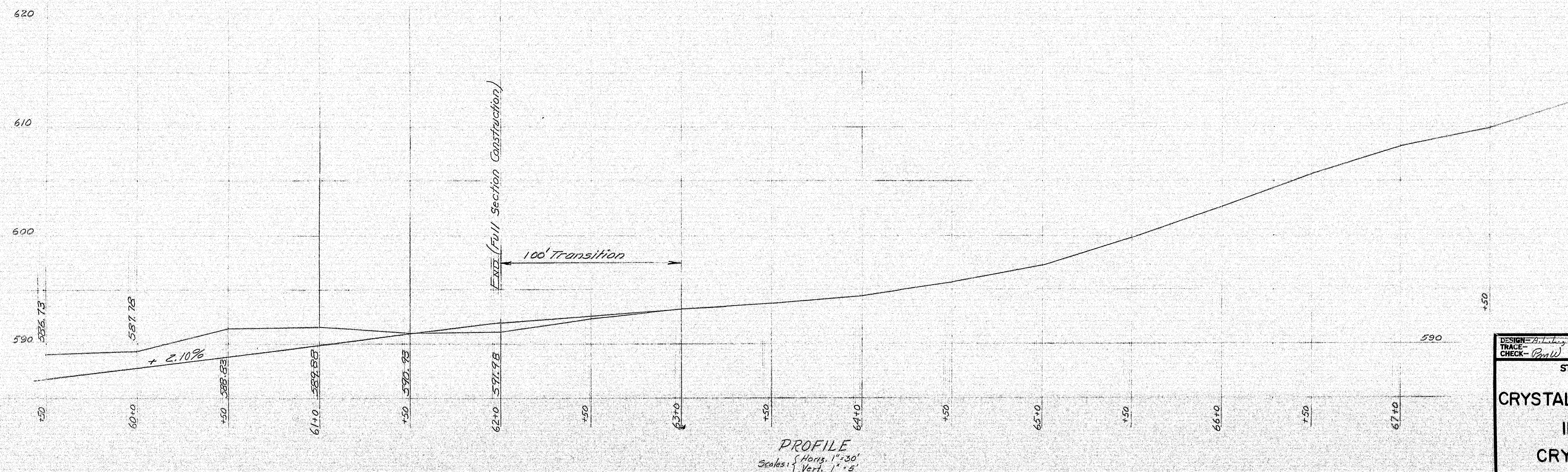
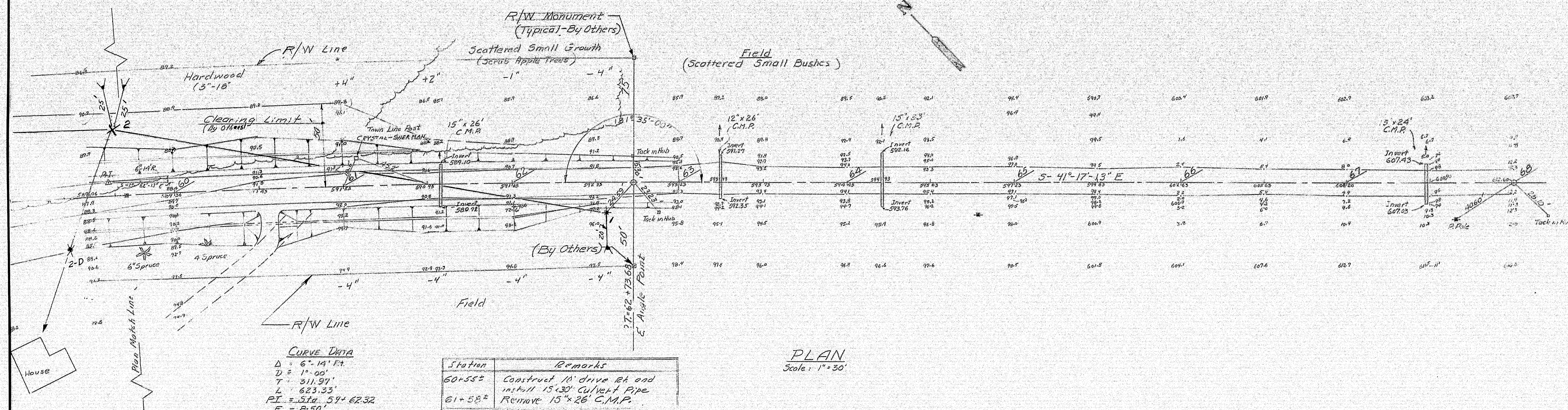

4 LANE REVISION NOVEMBER 1966  
 245 VAP

DESIGN: A.L.L., R.L.L. & A.H.R.      BRIDGE NO. 2004 116-95-10-7  
 CHECK: B.W.      SURVEY: F.B. & P. 116-95-10-7

STATE HIGHWAY COMMISSION  
 BRIDGE DIVISION

CRYSTAL STATION ROAD BRIDGE  
 OVER  
 INTERSTATE 95  
 IN THE TOWNS OF  
 CRYSTAL & SHERMAN  
 AROOSTOOK COUNTY  
 SURVEY

SHEET 8 OF 26 AUGUSTA, MAINE MAY 1965

101-8

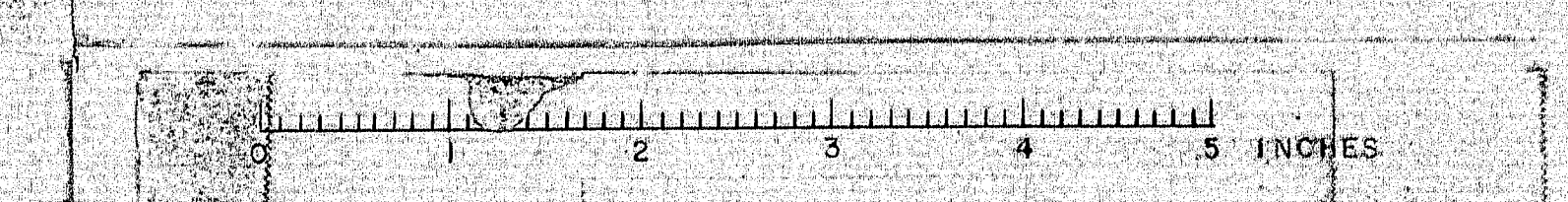







Highway  
No. 95  
R.L.L.  
10/1/55

95-1037

7

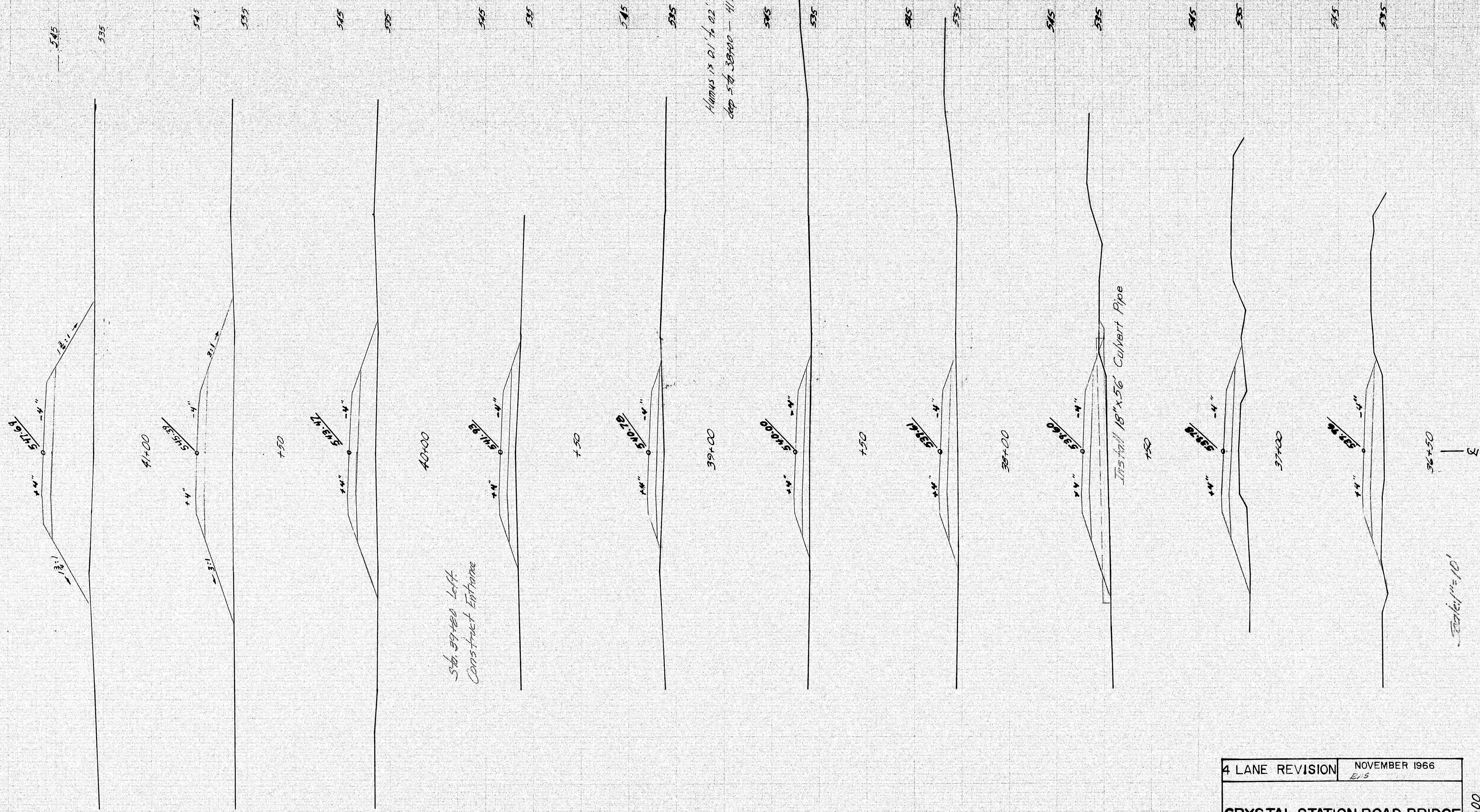

D. P. & R. NO.	STATE	PROJECT NUMBER	SHEET NO.	TOTAL SHEETS
1	MAINE	2-95-9(41)	10	26

4 LANE REVISION

NOVEMBER 1966

EV-5

CRYSTAL STATION ROAD BRIDGE

OVER

INTERSTATE 95

IN THE TOWNS OF

CRYSTAL & SHERMAN

AROOSTOOK COUNTY

CROSS-SECTIONS

SHEET 10 OF 26

JAN 1966

Sta 36+50 to 41+00



B. P. R. NO.	STATE	PROJECT NUMBER	SHEET NO.	TOTAL SHEETS
1	MAINE	1-28-9100	11	26

75-1037  
MOUNTAIN HILL  
MAY 65  
10-65

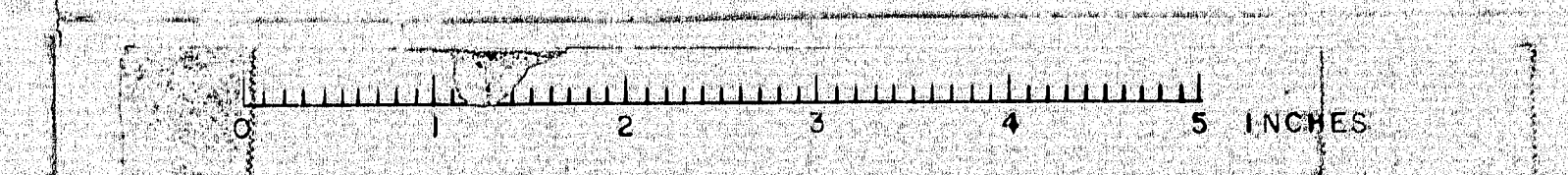
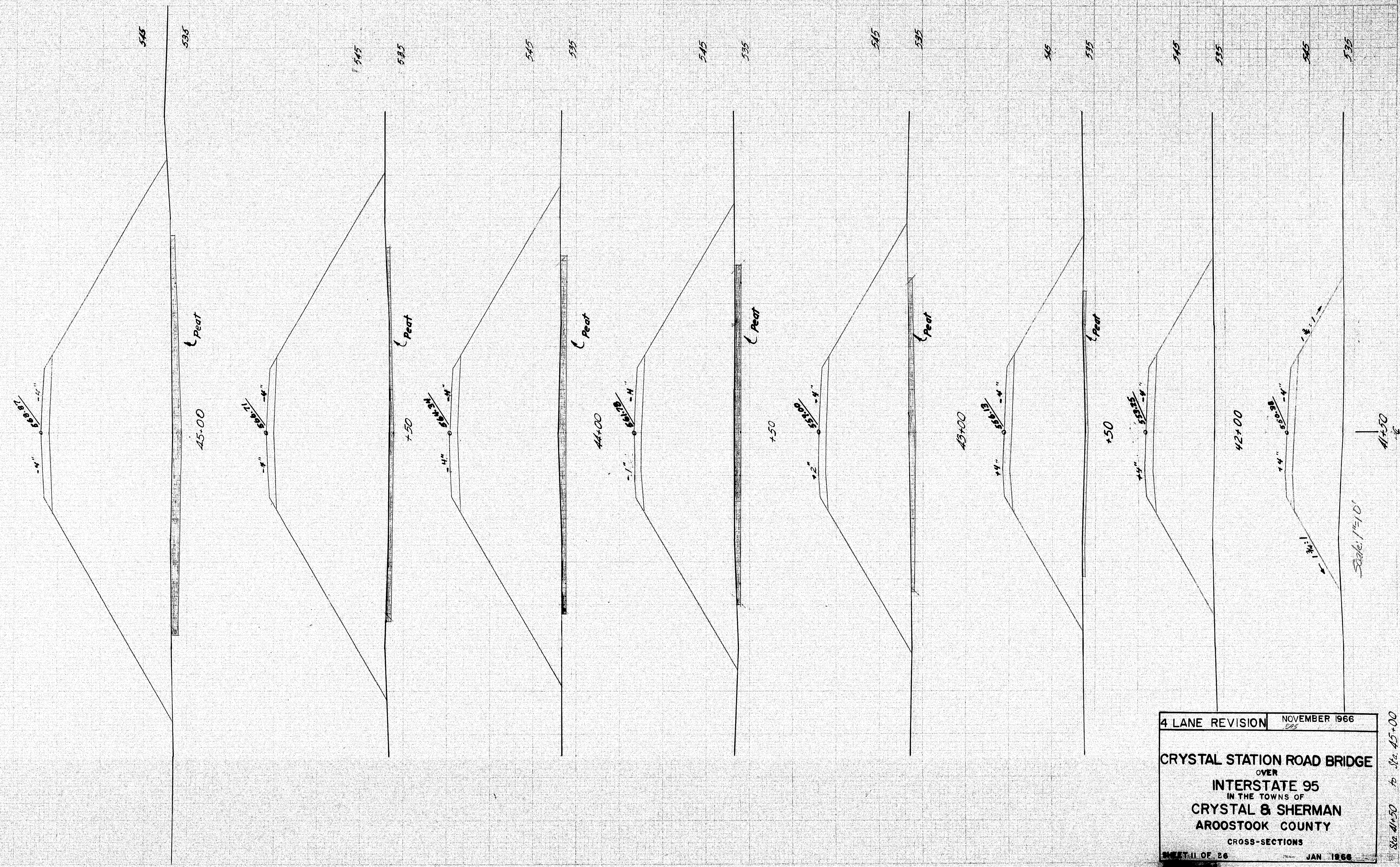

4 LANE REVISION NOVEMBER 1966

CRYSTAL STATION ROAD BRIDGE  
OVER  
INTERSTATE 95  
IN THE TOWNS OF  
CRYSTAL & SHERMAN  
AROOSTOOK COUNTY  
CROSS-SECTIONS

SHEET 11 OF 26 JAN 1966

Sta 41+50 to Sta 45+00



B. P. NO.	STATE	PROJECT NUMBER	SHEET NO.	TOTAL SHEETS
1	MAINE	2-95-9400	12	28

DESIGNED BY  
 8-1-107 4000  
 10-1-65  
 10-1-65

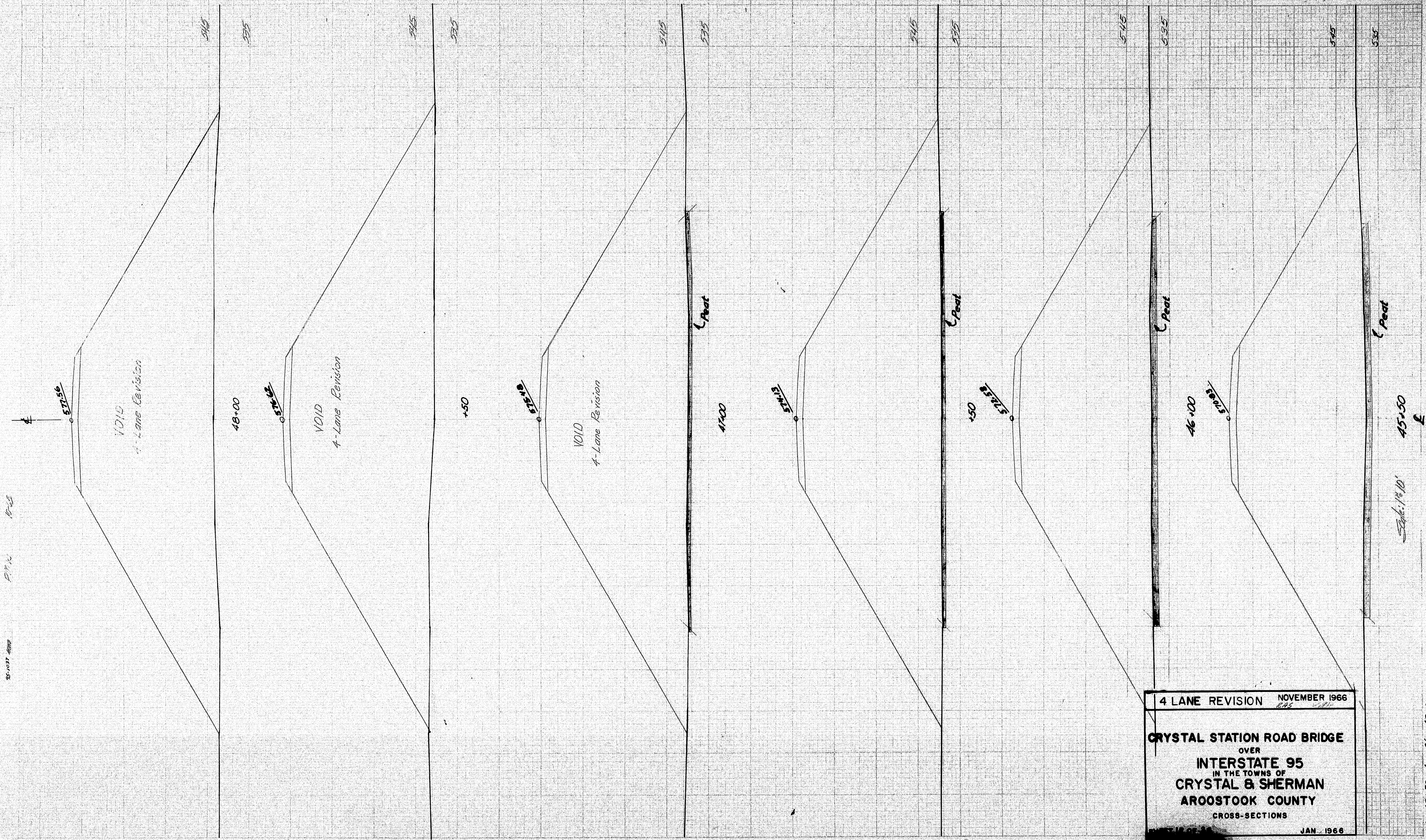

4 LANE REVISION NOVEMBER 1966  
 CRYSTAL STATION ROAD BRIDGE  
 OVER  
 INTERSTATE 95  
 IN THE TOWNS OF  
 CRYSTAL & SHERMAN  
 ARROSTOOK COUNTY  
 CROSS-SECTIONS  
 JAN. 1966

Sta 45+50 to Sta 48+00



U. S. H. NO.	STATE	PROJECT NUMBER	SHEET NO.	TOTAL SHEETS
1	MAINE	7-15-9742	18	28

DATE	
DESIGNED BY	
CHECKED BY	
APPROVED BY	

95-107	10-5
95-107	10-5
95-107	10-5

BRIDGE  
(Station 46+56.67 to 50+94.33) 4-Lane Revision

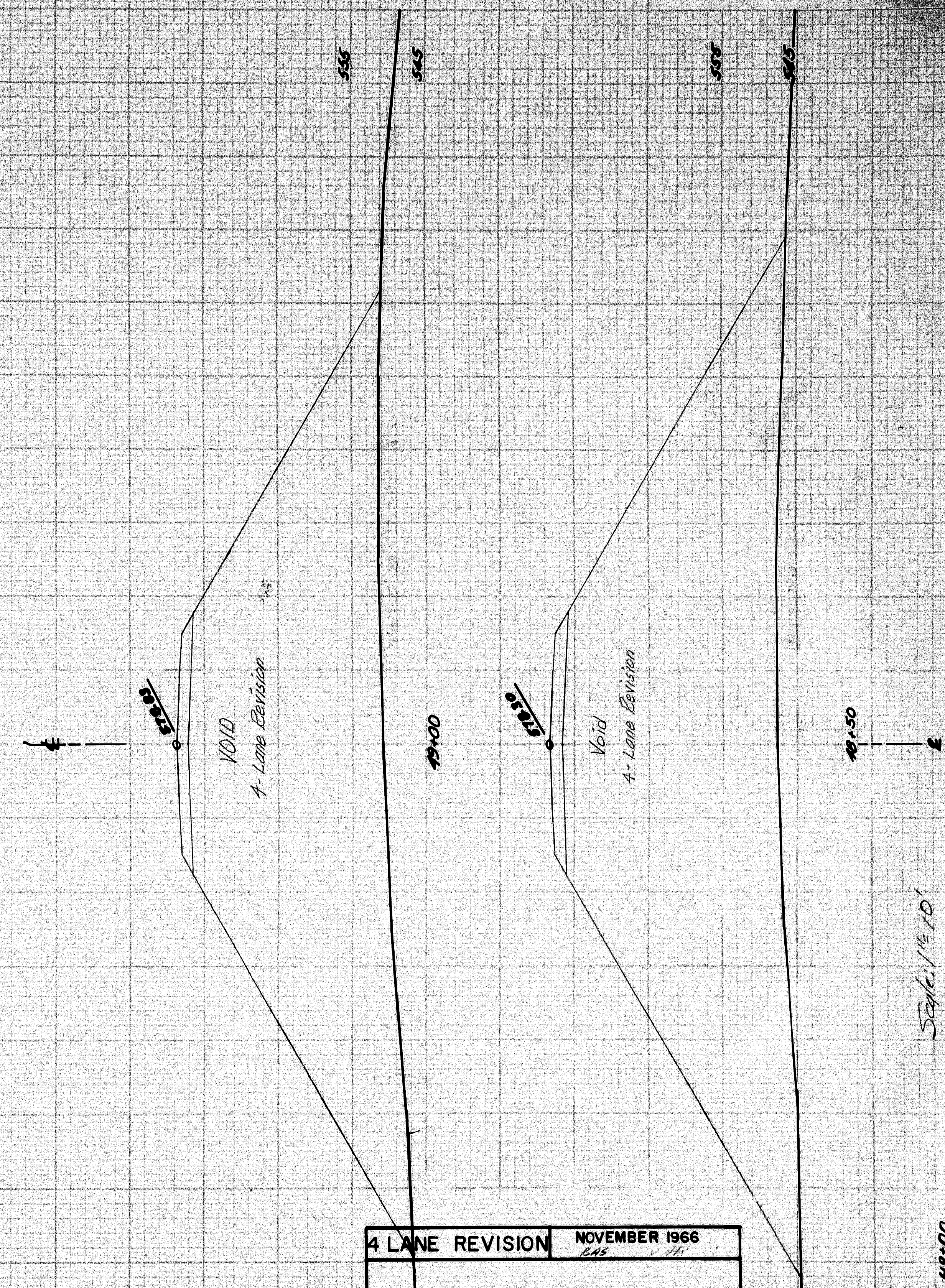

4 LANE REVISION NOVEMBER 1966  
 CRYSTAL STATION ROAD BRIDGE  
 OVER  
 INTERSTATE 95  
 IN THE TOWNS OF  
 CRYSTAL & SHERMAN  
 ARROOSTOOK COUNTY  
 CROSS-SECTIONS  
 SHEET 13 OF 18 JAN 1966

PLATE 3 - CROSS SECTION  
 CHARLES E. BROWN COMPANY, INC.

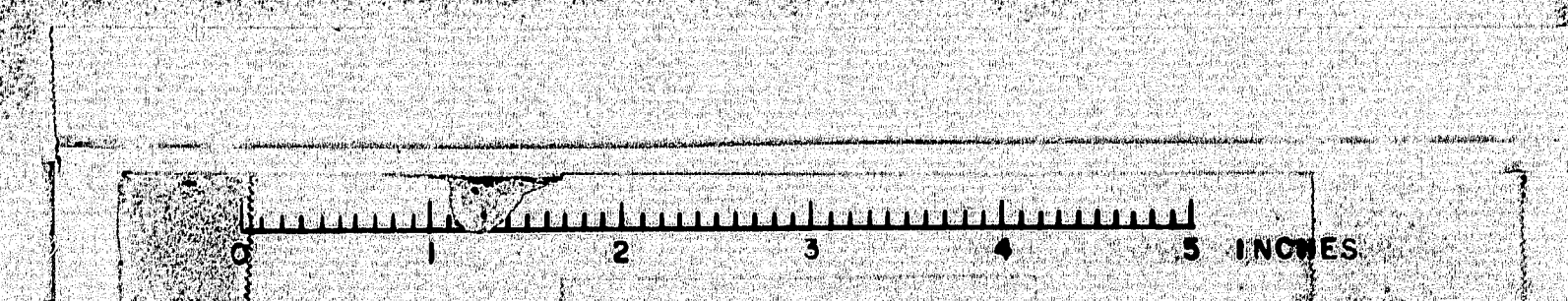

Scale 1" = 10'

Sta 46+50 to 49+00











DATE	
BY	
CHECKED	
APPROVED	

ORIGINAL	10-25-66
SURFACE	10-25-66
NOTES	10-25-66

STATE	PROJECT NUMBER	SHEET NO.	TOTAL SHEETS
MAINE	2-75-941	18	20

590 580 590 580 590 580 590 580 590 580 590 580

63+00

End of Transition

62+50

62+00

End (Full Section Construction)

61+50

61+00

60+50

60+00

Ledge outcrops on Right from station 60+97 to station 61+22.

See 60+55 to 10' drive

Install 15"x20" Culvert Pipe under drive

Scale 1"=10'

00000 01 00000 015

4 LANE REVISION

NOVEMBER 1966

STATE HIGHWAY COMMISSION  
BRIDGE DIVISION

CRYSTAL STATION ROAD BRIDGE

OVER

INTERSTATE 95

IN THE TOWNS OF

CRYSTAL & SHERMAN

AROOSTOOK COUNTY

CROSS-SECTIONS

AUGUSTA MAINE

JAN 1966

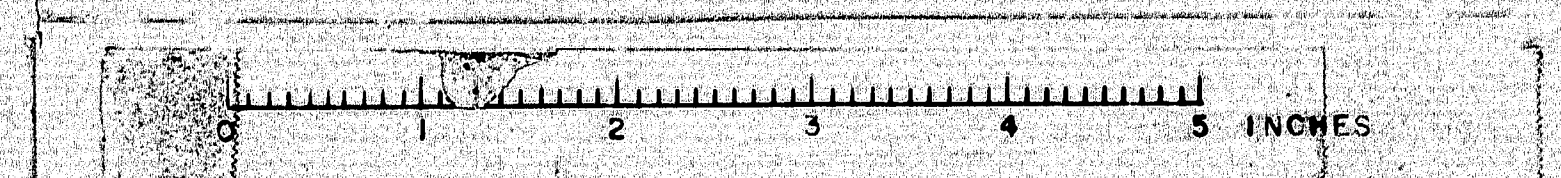

PLATE 3-CROSS SECTION



